

# Lead Investigators Guide

**Read** the *Confidential Brief* (SEE BACK). Extract and organize all evidence.

**Review** the Safe Log and Procedure, Office Map, and OVI Pen information

**Review** *Anti-Matter* Document.

**Get** answers from your team of experts for the questions below.

## Work with Physical Evidence Expert

**Your best tool** is to have well organized evidence.

Know which suspect each piece of evidence is linked.

## Work with the Interrogation Experts to:

- Get a story of what happened from each suspect
- Fill in missing information or explain contradictions.
- Ask specific questions you need answered by one or more of the suspects.
- Use evidence against suspects to get new information.

## QUESTIONS FOR FINGERPRINT EXPERTS

1. 3 fingerprints on safe matching which 3 suspects?
2. Whose prints are on the flashlight? Where?
3. Whose prints are on the *Yachts* magazine  
Where are the prints located?
4. Whose prints are on the wine bottle?  
Where are they located?

## Questions for DNA Experts

What can we learn from DNA samples found on: **(1)** Flashlight **(2)** Towel and **(3)** Blue Pen

## QUESTIONS FOR PHYSICAL EVIDENCE

1. Blood on the torn black shirt found by the fence matches which suspect?
2. 2 types of carpet evidence matching which suspect?
3. Whose DNA is found on the towel?
4. What blood type is found on the towel?
5. What is the fluid evidence on the Official Documents?
6. Whose DNA is on the flashlight?
7. Who does the writing in *Yachts* magazine implicate?

## QUESTIONS FOR LAB EXPERTS

What is the blood type for each suspect?

Dom \_\_\_\_ Rolph \_\_\_\_ Vivian \_\_\_\_ Ethan \_\_\_\_

Hair Sample in safe matches who?

Hair Sample found on Ethan's chair matches?

Footprint Evidence points to which suspect?

Tire Tread Evidence points to which suspect?

## QUESTIONS FOR INK EVIDENCE EXPERTS

Can we verify the Ink Evidence Sources are linked to suspects? If so, who?

Black Pen \_\_\_\_\_ Blue Pen \_\_\_\_\_

OVI \_\_\_\_\_ Printer \_\_\_\_\_

What can we confirm about Ink Evidence on:

- Magazine
- Shredded Document Fragments
- Official Documents

There are three sources of ink evidence on the Shredded Document fragments, 2 signatures and the ink it was printed on,

Whose story do they confirm?

# Confidential Brief



**CLASSIFIED**

## BRIEF: GLOBAL ENERGY RESEARCH AND DEVELOPMENT ADMINISTRATION

IN THE LAST HOUR OUR WORLD HAS BEEN THREATENED WITH THE THEFT OF **ANTI-MATTER**. YOU HAVE APPROXIMATELY 2 HOURS TO SOLVE THE CASE. THE ANTI-MATTER WAS STOLEN FROM A RESEARCH COMPANY, *MATTERMATTERS CORP*. IF THE ANTI-MATTER GETS SOLD ONTO THE BLACK MARKET, WORLD SECURITY AS WE KNOW IT WILL NO LONGER EXIST.

## CRIME SCENE DESCRIPTION: **STOLEN ANTI-MATTER**

CEO ETHAN MEYERS WAS FOUND IN HIS OFFICE BEING ATTENDED TO BY PARAMEDICS FOR A GASH IN THE BACK OF HIS HEAD. BEHIND HIM IS A HIGH SECURITY SAFE. FINGERPRINTS WERE FOUND ON THE SAFE AND HAIR SAMPLES INSIDE THE SAFE AND ON ETHAN'S CHAIR. AN UN-OPENED **BOTTLE OF WINE** IS LYING ON THE FLOOR. THE SAFE WAS CLOSED WHEN INVESTIGATORS ARRIVED.

ETHAN MEYER'S OFFICE IS ONE OF THE HIGHEST SECURITY OFFICES IN THE WORLD. ONLY HE HAS SOLE ACCESS TO IT. ON THE DAY OF THE CRIME AND THE PREVIOUS DAY, ONLY 3 PEOPLE, BESIDES **ETHAN**, HAD ENTERED HIS OFFICE: **DOMINIQUE MONROE**, HIS EXECUTIVE SECRETARY; **ROLPH WIESFORDT**, HIGH LEVEL FACILITY ENGINEER; AND **VIVIAN O'BRIEN**, HIGH LEVEL SECURITY OFFICER. THESE **4 PEOPLE** ARE THE ONLY ONES TO HAVE **MEANS** AND **OPPORTUNITY** TO STEAL THE ANTIMATTER. **MOTIVE** CAN BE ACCOUNTED FOR BY THE 1 BILLION DOLLAR BLACK MARKET VALUE OF THE ANTIMATTER. THE THEFT TOOK PLACE AT APPROXIMATELY **12:30PM** DURING A POWER OUTAGE.

A SLIGHT GLIMPSE OF WHAT WAS DESCRIBED AS SOMEONE "EXITING THE PREMISES OVER THE 10 FOOT RAZOR WIRE FENCE AND AN ITEM FALLING TO THE GROUND" WAS DISCOVERED FROM THE VIDEO SURVEILLANCE CAMERAS AND **TIME STAMPED AT 11:00AM**. THE AREA WAS SEARCHED AND YIELDED THE FOLLOWING: ONE SMALL PIECE OF **RIPPED T-SHIRT** WITH A SMALL BLOOD SAMPLE WAS FOUND HANGING ON THE RAZOR WIRED FENCE THAT SURROUNDS THE BUILDING. A **FLASHLIGHT** AND **SHOEPRINT** WERE FOUND JUST INSIDE THE FENCE NEAR WHERE THE T-SHIRT STRIP WAS DISCOVERED. FRESH **TIRE PRINTS** WERE DISCOVERED IN THE MUD OUTSIDE OF THE FACILITY ON A DIRT ACCESS ROAD.

**DOMINIQUE'S OFFICE** HAS BEEN SEARCHED, IN HER GYM BAG WAS FOUND A **DAMP TOWEL** KEPT AS POSSIBLE EVIDENCE. **ROLPH'S LOCKER** WAS SEARCHED AND A "**YACHTS**" MAGAZINE WAS FOUND AND SOME **CHEWED BLUE INK PENS**. **ALL EVIDENCE HAS BEEN SENT TO YOUR TEAM FOR PROCESSING.**

**YOUR MISSION**, SHOULD YOU CHOOSE TO ACCEPT IT,  
**FIGURE OUT WHO STOLE ANTI-MATTER AND BE ABLE TO PROVE IT!**

### SAFE LOG

9:24 AM OPEN

9:30 AM CLOSE

12:32 PM EMERGENCY OPEN

**NOTE: ANTI-MATTER STOLEN HERE**

12:34 PM CLOSE - **SHUTDOWN** -  
**MANUAL LOCKDOWN MODE**

1:17 PM HIGH SECURITY OPEN

3 PERSON PROTOCOL REQUIRED

**CURRENT STATUS - OPEN**

### SAFE POWER OUTAGE PROCEDURE

*SEC 14:B*

*ARTICLE 7*

IN CASE OF POWER OUTAGE

SAFE WILL OPEN 1 TIME **ONLY** IF  
STAKEHOLDER VIP IS PRESENT.

THIS FUNCTION IS DESIGNED TO ALLOW  
STAKEHOLDER TO ADD OR REMOVE ANY ITEMS  
BEFORE SAFE GOES INTO **MANUAL LOCKDOWN**.

MANUAL LOCKDOWN REQUIRES A THREE PERSON  
PROTOCOL TO OPEN SAFE AS OUTLINED IN:  
*SEC 17:A-E ARTICLE 4*

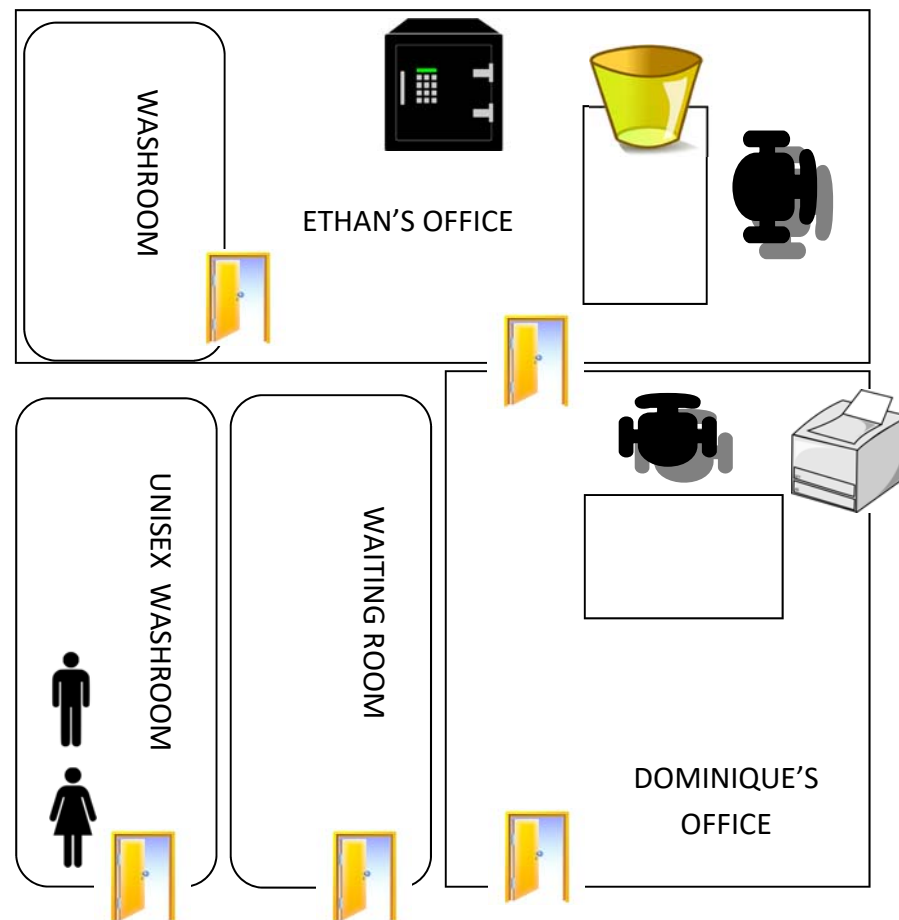

**OVI Security Pens** are designed to give a unique signature for VIPs by creating a customized, one-of-a-kind, ink formula that is both invisible to the naked eye and 100% unique to the stakeholder. They stand in court as a near 100% reliability source in terms of authenticating very important signatures.

Owners invariably keep them inside a high security safe at all times, and usually only remove them when signing important documents.

# ANTI-MATTER



Antimatter has many lucrative uses as it is an extremely powerful energy source and extremely rare.

It can be used as a weapon that uses antimatter as a power source, a propellant, or an explosive.

Antimatter weapons are rare due to the cost of production and the limited technology available to produce and contain anti-matter in sufficient quantities



Antimatter production and containment are major obstacles to the creation of antimatter weapons. **Quantities measured in grams** are required to achieve destructive effect comparable with conventional nuclear weapons.

The basic equation governing the antimatter reaction is Einstein's famous  $E = mc^2$ , except with the slight modification  $E = 2mc^2$ .

- **One gram of antimatter** annihilating with one gram of matter **produces 180 Tera joules**, the equivalent of 43 kilotons of TNT: **3x the power of the bomb dropped on Hiroshima!**
- The container above was stolen from Mattermatters Inc. containing 20 grams of pure Anti-Matter; enough to make **20lbs of weapons grade Anti-Matter material: THAT IS OVER 9,000 GRAMS OF WEAPONS GRADE ANTI-MATTER**

## **CURRENT STATUS:**

After an extensive search no trace or sign of the Anti-Matter has been found on premises.

After extensive interviews and records review it has been determined that the Anti-Matter likely left the building on someone's person, or through the plumbing. The building went into **complete lockdown at approximately 12:39 PM.**

A plumbing crew was granted access to the facility at **11:25 AM** and was recorded leaving at **12:38 PM**. Records show work in the Sub-Basement and on areas near Ethan's office. We have yet to determine the identity of the plumbing crew.